

MEETING MINUTES
TUESDAY, FEBRUARY 19, 2019
10:00 – 11:30 AM
ACADEMIC OFFICE ONE, 7TH FLOOR BOARDROOM

EXECUTIVE COMMITTEE MEETING

PRESENT:

John J. Reilly, Jr., MD, Dean, School of Medicine and Chair

MEMBERS: Leslie Berg, PhD; Evalina Burger, MD; Stephen Daniels, MD, PhD; Frank deGruy, MD; C. Neill Epperson, MD; Herman Jenkins, MD; Mark Johnston, PhD; Brian Kavanagh, MD, MPH; Kevin Lillehei, MD; Wendy Macklin, PhD; Naresh Mandava, MD; David Norris, MD; Connie Savor Price, MD; David Raben, MD; Angie Ribera, PhD; Richard Schulick, MD, MPH; Ron Sokol, MD MBA; Ann Thor, MD; Vesna Todorovic, MD, PhD, MBA; Ken Tyler, MD; Richard Zane, MD

GUESTS: Peter Buttrick, MD; John Caldwell, PhD; Karen Chacko, MD; Mark Couch; Harold “Corky” Dillon, MD; Jeffrey Druck, MD; Robert Eckel, MD; Thomas Flaig, MD; Anne Fuhlbrigge, MD; Steven Lowenstein, MD, MPH; Sarah Miller; Christina Osborne, MD; C. Lee Parmley, MD; Connie Savor Price, MD; Judy Regensteiner, PhD; Marian Rewers, MD, PhD; Suzann Ruedeman; Carol Rumack, MD; Jane Schumaker; Judy Sherman, Vanessa Valesquez; Cheryl Welch; Cara Wilson, MD; Susan Zacharakis; Shanta Zimmer, MD

MEMBERS NOT PRESENT: Venu Akuthota, MD; John Caldwell; Michael Cancro; Karen Chacko, MD; Gerald Dodd, MD; Nicole Draper, MD; Chancellor Don Elliman; Jena Hausmann; Michael Ho, MD; Sallie Houser-Hanfelder; Christopher Kleck, MD; Nanette Santoro, MD; David Schwartz, MD; Andrew Thorburn, DPhil; Kathleen Torkko, PhD; Erik Wallace, MD

I. GREETINGS – Dean Reilly

II. APPROVAL OF MINUTES

The January 15, 2019, meeting minutes were adopted unanimously as presented.

III. DEAN’S UPDATES

Leslie Berg, PhD, assumed her position as the new chair of the Department of Immunology and Microbiology on February 1, 2019.

Kathryn Wells, MD, is the new director of the Kempe Center for the Prevention and Treatment of Child Abuse and Neglect.

There are two active leadership searches underway for the school. There are three finalists for senior associate dean for administration and finance. Two of the finalists interviewed over the last two weeks and the third finalist will be interviewing the week of February 25. The school is also in later stages for the search for the chair of the Department of Biochemistry and Molecular Genetics and one candidate has been invited back for a final visit.

The February dean's updates include a list of proposed bills in the Colorado state legislature regarding various aspects of healthcare. The bills do not address the status of the Colorado Governmental Immunity Act and current conversations with legislator indicates that they will not be changing those statutes. One of the bills provides funding for the rural track scholarships and several others deal with various aspects of transparency and cost reporting in medicine.

The school is proceeding well through the exercise of developing a child's health research strategy with Children's Hospital Colorado and outside consultants.

UCHealth system board approved construction of the third inpatient tower at University of Colorado Hospital. Preliminary work on the tower will begin this summer 2019 and construction will begin this fall 2019.

On January 30 a groundbreaking ceremony was held for the new Anschutz Health Sciences Building being constructed directly west of Research Building Two. Completion of the building is anticipated by the summer of 2021.

IV. DISCUSSION ITEMS

A. Updates on campus geography: research space and AO1 red carpet club: *Peter Buttrick, MD, Senior Associate Dean for Academic Affairs (see attached slides for additional information).*

Dr. Buttrick discussed the ongoing issue of research space on the campus. Department chairs were recently sent data on their department's research space utilization based on dollars per square feet.

As indicated recently by Dean Reilly in his State of the School address, the school is not out of wet lab space and there are no plans to build new wet lab space in the future. However, this does not mean the school is not recruiting wet lab scientists, but rather that current space needs to be utilized more efficiently.

Overall, departments need to identify wet vs. dry vs. 'damp' research space. The infrastructure/space needed for 'damp' research space is much different than what is needed for 'wet' lab space. Departments also need to consider occupancy vs. dollars as space is a limited resource. On average, there are currently between two-three researchers who occupy each module, which is slightly less than 50% occupancy. Lastly,

departments need to be better at utilizing current space. Labs should not be used as storage space for equipment. Those who need assistance in removing excessive/unused equipment can contact Suzann Ruedeman, Director of Planning and Facilities, Suzann.ruedeman@ucdenver.edu.

Construction is underway for the first floor of Academic Office Building One with an expected occupancy by June-July 2019. The new space will be clinically focused for occupancy, specifically, faculty who are > 50% MD's/APP's, and others who are underutilizing office space (especially in Research Building One and Two).

Dr. Reilly noted that vivarium is currently the most expensive space per sq foot on the campus. There are three potential projects that would address the current capacity issues in the vivarium. The first is the expansion of the space currently being used for zebra fish. The second is to build out the currently under-utilized shelled space under Research Building Two. The third is how/when to build out the 29,000 sq. feet that will be under the new Anschutz Health and Sciences Building. The school received estimates on costs for each of those projects, which are \$4 million, \$8 million, and \$40 million, respectively. Jori Leszczynski, DVM, Director for the Office of Laboratory Animal Resources, and her team are assembling a grant application to achieve the first two goals, which would require co-investment from the University. If successful, the school would receive an additional \$8 million in extramural funding for the first two projects.

B. Faculty Senate Updates: *David Raben, MD, professor of radiation oncology, Faculty Senate President:* The February faculty senate meeting was held on Tuesday, February 12, 2019. Laura Borgett, PharmD, FCCP, BCPS, Associate Dean for Administration and Operations, Skaggs School of Pharmacy, provided updates on the current search for a new CU president. Kimberly Mueller, managing director of CU Innovations, provided an update on the CU Innovations office. CU Innovations focuses on bringing investors/entrepreneurs to invest in new research ideas on the campus and introduce faculty to potentially new business partnerships and commercialization/grant funding programs (i.e. SPARK); CDI Fund (Chancellor's Discovery Innovation Fund).

Dr. Reilly mentioned that the Board of Regents and search committee both met last week to review candidates for the CU presidential search. The committee received approximately 160 nominations and will review candidates and present names to the board. President Benson is currently scheduled to step down July 1, 2019.

C. Affiliate Updates:

Denver Health: *Connie Savor Price, MD, Chief Medical Officer:* Denver Health is in negotiations with a finalist for director of service for radiology and is also in the final round of the search for director of service for obstetrics and gynecology.

Denver Health also received applications for director of service for orthopedics. There are other current searches for staff positions in interventional cardiology, child psychiatrist, acute care surgeons, and a staff radiologist. The Denver Health Foundation's annual NighShine Gala is coming up on Saturday, March 30, 2019. Proceeds from this year's event will support Denver Health's level 1 trauma center.

EXECUTIVE SESSION

I. APPROVAL ITEMS

- A.** Sr. clinical appointments and promotions committee actions were approved unanimously.
- B.** Faculty promotions committee actions were approved unanimously.
- C.** The professor emeritus appointment was approved unanimously.

II. FYI ITEMS

The meeting was adjourned at 11:05 a.m.

Search Updates

Interviews with finalists for the position of Senior Associate Dean for Administration and Finance and Executive Director of University of Colorado Medicine are underway.

Affiliate Updates

UCHealth University of Colorado Hospital announced that it will build a new 11-story tower on the Anschutz Medical Campus. The tower will initially provide 103 additional inpatient beds and nine operating rooms, with space for future growth. Construction of the new tower will start in 2019, and it is expected to open in 2022.

Legislative Updates

The University of Colorado Office of Government Relations is monitoring and has contacted campus subject matter experts regarding bills under consideration at the Colorado General Assembly:

- **House Bill 19-1001** requires the Colorado Department of Health Care Policy and Financing to develop an annual report detailing uncompensated hospital costs. The bill has passed the House and has been introduced in the Senate.
- **House Bill 19-1009** provides funding to support housing assistance for individuals with a substance abuse disorder and creates an opioid crisis recovery fund. Introduced in the House.
- **House Bill 19-1010** creates a freestanding emergency department license. Hearing in the House Appropriations Committee on Tuesday, February 12.
- **House Bill 19-1041** requires hospitals and ambulatory surgical centers to adopt and implement a policy eliminating surgical smoke. Passed House and introduced in Senate.
- **House Bill 19-1076** adds e-cigarettes to the Colorado Clean Indoor Air Act. Introduced in House.
- **House Bill 19-1083** changes regulation of athletic trainers from registration to licensure. Pending in House.
- **House Bill 19-1120** allows a minor 12 years or older to seek and obtain psychotherapy services without consent of the minor's parent or guardian. Introduced in House.
- **House Bill 19-1168** creates a reinsurance program to provide reinsurance payments to health insurers to aid in paying high-cost insurance claims. Introduced in House.
- **House Bill 19-1088** extends availability of the health care preceptor tax credit through tax year 2024 and modifies definition of preceptorship from lasting four weeks to lasting four working weeks, or 20 business days. Pending in House Finance.
- **House Bill 19-1095** eliminates restriction limiting how many physician assistants may be supervised by a licensed physician and other changes. Introduced in House.
- **Senate Bill 19-001** expands the medication-assisted treatment pilot program, administered by the CU College of Nursing, from its current two counties to include counties in the San Luis Valley and two additional counties. Pending in Senate Appropriations Committee.
- **Senate Bill 19-004** authorizes the state personnel director to explore offering, and, if feasible, creating a pilot program to offer group medical benefits available to state employees to those living in an area of the state affected by high health insurance premiums. Introduced in Senate.

- **Senate Bill 19-005** calls on the Colorado Department of Health Care Policy and Financing to design a program to import prescription pharmaceutical products from Canada for sale to Colorado consumers. Pending in Senate Appropriations Committee.
- **Senate Bill 19-008** addresses substance abuse treatment for persons in the criminal justice system. Introduced in Senate.
- **Senate Bill 19-013** expands the list of disabling medical conditions that are authorized to use medical marijuana to include conditions for which a physician could prescribe an opiate. Pending in Senate.
- **Senate Bill 19-079** requires medical professionals to use electronic prescribing of opioids effective July 1, 2021. Passed Senate and introduced in House.
- **Senate Bill 19-133** would require a license to practice genetic counseling. Introduced in Senate.

Institutional Updates

The University of Colorado Anschutz Medical Campus on Wednesday, January 30, broke ground on the Anschutz Health Sciences Building, which will be constructed west of Research 2. The new building, scheduled to be completed in mid-2021, will serve as the home for personalized medicine, translational science, mental and behavioral health programs, and a patient simulation center.

The Anschutz Medical Campus held a celebration on Monday, February 4, to commemorate the naming the Health Sciences Library in honor of Henry L. Strauss, an alumnus of the University's school of pharmacy. Gov. Jared Polis attended the event.

The University of Colorado announced that it has launched a \$4 billion fundraising campaign for all CU campuses to support education, research, faculty recruitment and retention, and health care initiatives. So far, CU has raised \$2 billion in the quiet phase of the campaign, which began in late 2013.

Kathryn Wells, MD, associate professor of pediatrics, has been named the next executive director of the Kempe Center and head of the Department of Pediatrics Section of Child Abuse and Neglect, succeeding Desmond Runyan, MD, DrPH, professor emeritus of pediatrics.

Faculty Senate Meeting

March 19, 2019

David Raben, M.D.

Faculty Senate President



School of Medicine

UNIVERSITY OF COLORADO ANSCHUTZ MEDICAL CAMPUS

Today's Agenda

**AGENDA
FACULTY SENATE
UNIVERSITY OF COLORADO SCHOOL OF MEDICINE**

March 19, 2019

4:30 – 5:30 p.m.

**Location: Anschutz Medical Campus
Academic Office 1 Building, E. Chester Ridgway Boardroom (7th Floor)**

- I. Welcome – Faculty Senate President David Raben**
- II. Approval of Minutes from February 12, 2019, meeting**
- III. Dean's Comments**
 - Status of searches and affiliations
- IV. Presentations and Discussion Items**
 - 1. Employee Benefits Update**
Michelle Martinez, Director of Strategic Benefits Initiatives, Employee Services University of Colorado.
 - 2. CU Medicine Contract Process Update**
Elizabeth Kissick, Vice President, Payor Relations and Network Development, University of Colorado Medicine;
Michelle Woulfe, Contract Operations Manager, University of Colorado Medicine;
Carrie Valdez, Associate Director of Finance, University of Colorado Medicine.

Executive Committee and Faculty Senate minutes are available on the web at:
<http://medschool.ucdenver.edu/faculty> at the Executive Committee and Faculty Senate links.

Please contact Cheryl Welch at 303-724-5356 or Cheryl.welch@ucdenver.edu if you have any questions.



School of Medicine

UNIVERSITY OF COLORADO ANSCHUTZ MEDICAL CAMPUS

Here are some of the best things to love about March

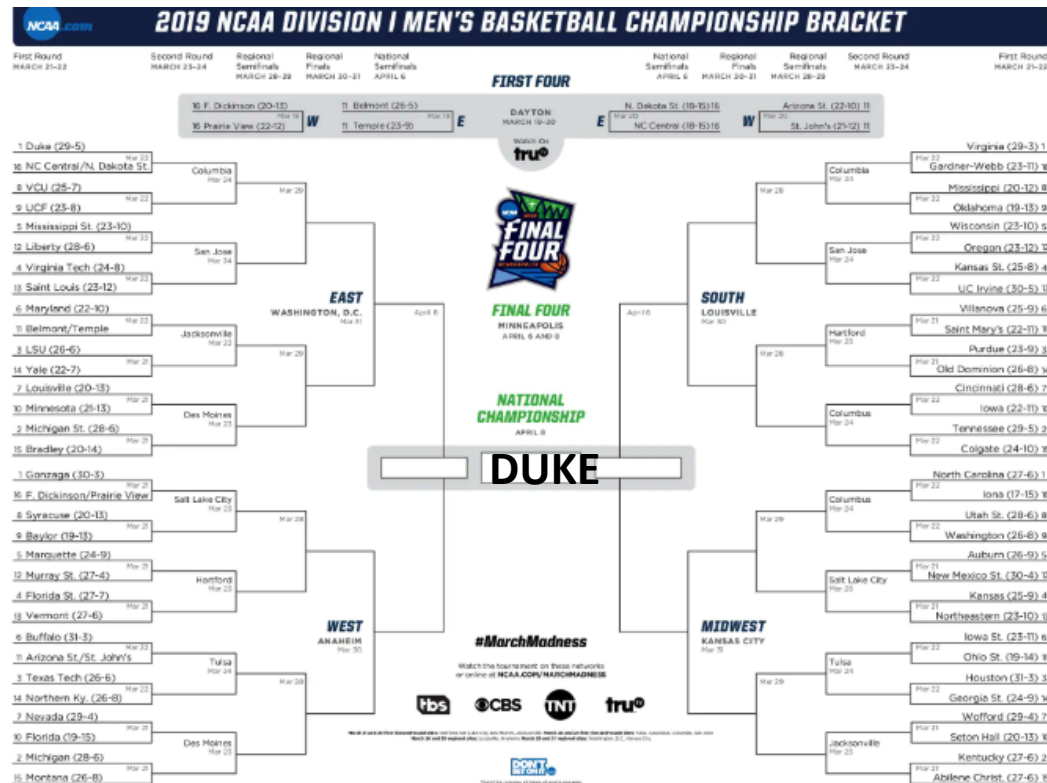

2019 NCAA tournament: Schedule, scores



School of Medicine

UNIVERSITY OF COLORADO ANSCHUTZ MEDICAL CAMPUS

Review of topics discussed from February Faculty Senate Meeting

Dean Reilly Updates:

- Leslie Berg – Chair
Immunology/Microbiology
- Chair search for Biochem/Molec Bio
is concluding
- 3 finalists for Sr Associa Dean for
Admin/Finance
- Groundbreaking for new Anschutz
Health Sciences Bldg on Jan 30th,
2018; approval for a 3rd inpatient
tower - 2.5 years
- Highlands hospital opening May 7

Laura Borgelt Update on Presidential Search:

- Search firm in place
- Comm provides recommendations to
the Board of Regents
- All campuses are providing input

Kim Muller Updates on CU Innovations



School of Medicine

UNIVERSITY OF COLORADO ANSCHUTZ MEDICAL CAMPUS

What Does CU Innovations Do?



- Our role is to nurture disruptive innovations into clinical and commercial reality through supporting:



CAMPUS INVENTORS



CLINICAL VALIDATION



INDUSTRY PARTNERSHIPS



School of Medicine

UNIVERSITY OF COLORADO ANSCHUTZ MEDICAL CAMPUS

Colorado's Healthcare Innovation Hub on the Anschutz Medical Campus

*Your One
Stop Shop For
Innovation*

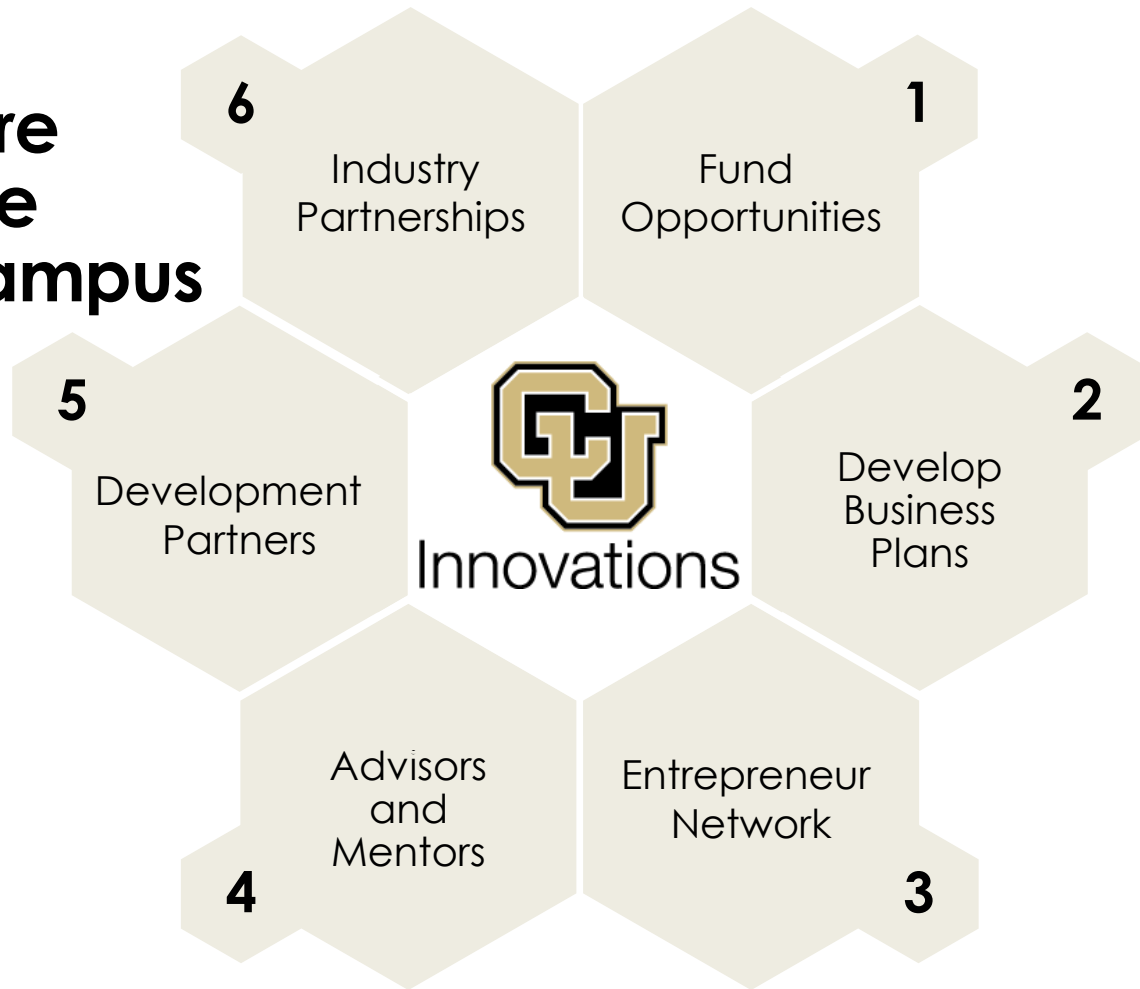

School of Medicine

UNIVERSITY OF COLORADO ANSCHUTZ MEDICAL CAMPUS

SPARK Colorado: Accelerator Program



Shifting academic discovery research into product development through:

Funding



Mentorship



Training



School of Medicine

UNIVERSITY OF COLORADO ANSCHUTZ MEDICAL CAMPUS

1. Approval of Minutes

2. Dean's comments and updates



School of Medicine

UNIVERSITY OF COLORADO ANSCHUTZ MEDICAL CAMPUS

PARTNERING WITH Innovations

*Helping Bring Your
Knowledge And
Discoveries Forward for
the Benefit Of Society*

Kimberly Muller, Esq
Managing Director
CU Innovations



Who Is CU Innovations?



Our mission is to bring together industry partners, entrepreneurs, and investors to help CU researchers solve important problems and improve the quality of life worldwide.

We strive to enable scientific research that could benefit society, while also generating a sustainable revenue stream for research.

What Does CU Innovations Do?



- Our role is to nurture disruptive innovations into clinical and commercial reality through supporting:



CAMPUS INVENTORS



CLINICAL VALIDATION



INDUSTRY PARTNERSHIPS

CU Innovations Leadership



STEVEN
VANNURDEN



Executive Director of
Biotechnology at the
University of Colorado

Past Experience:



KIMBERLY
MULLER



Managing Director of
CU Innovations at the
University of Colorado

Past Experience:



Colorado's Healthcare Innovation Hub on the Anschutz Medical Campus

***Your One
Stop Shop For
Innovation***

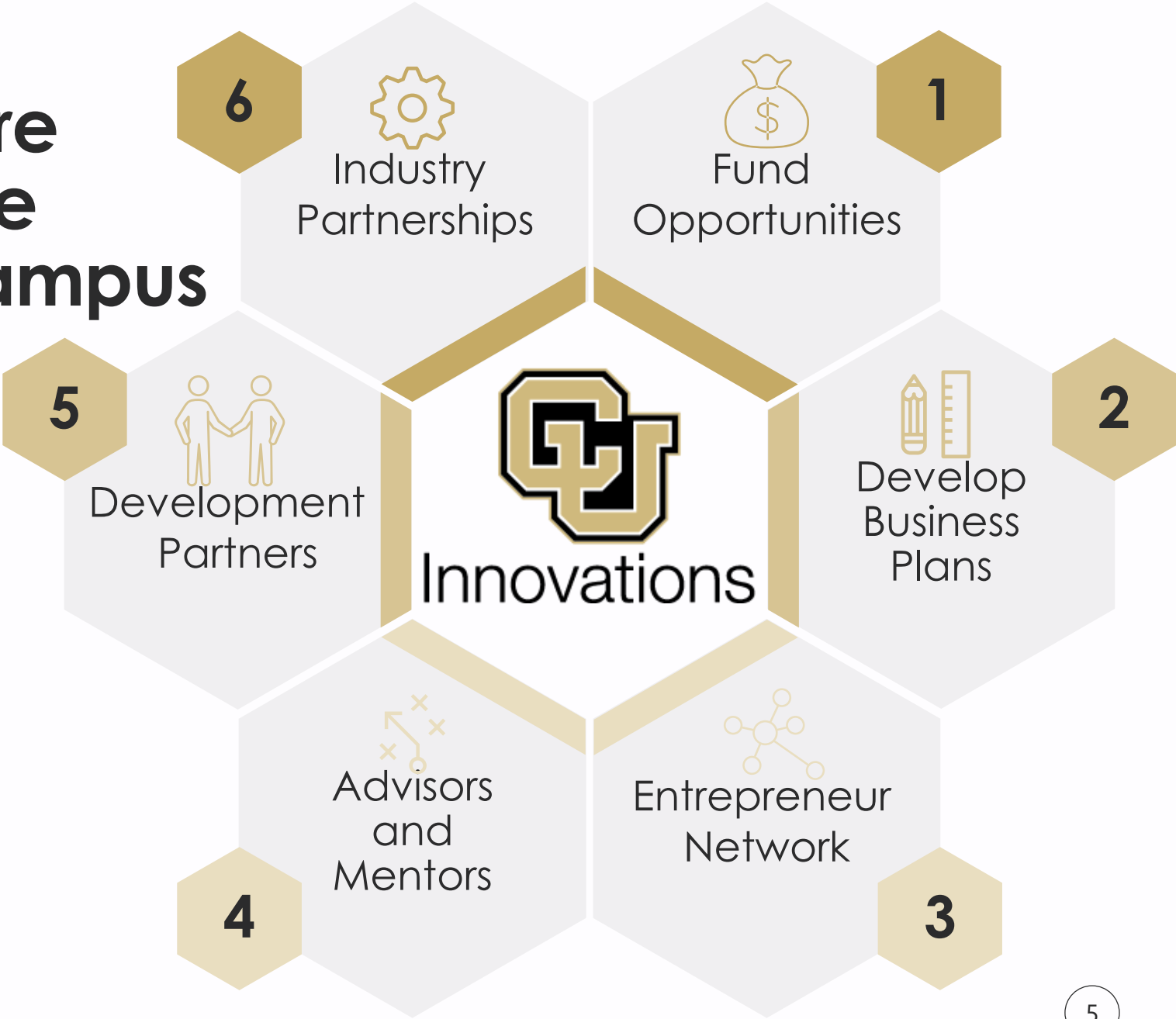

Innovation Ecosystem 2019

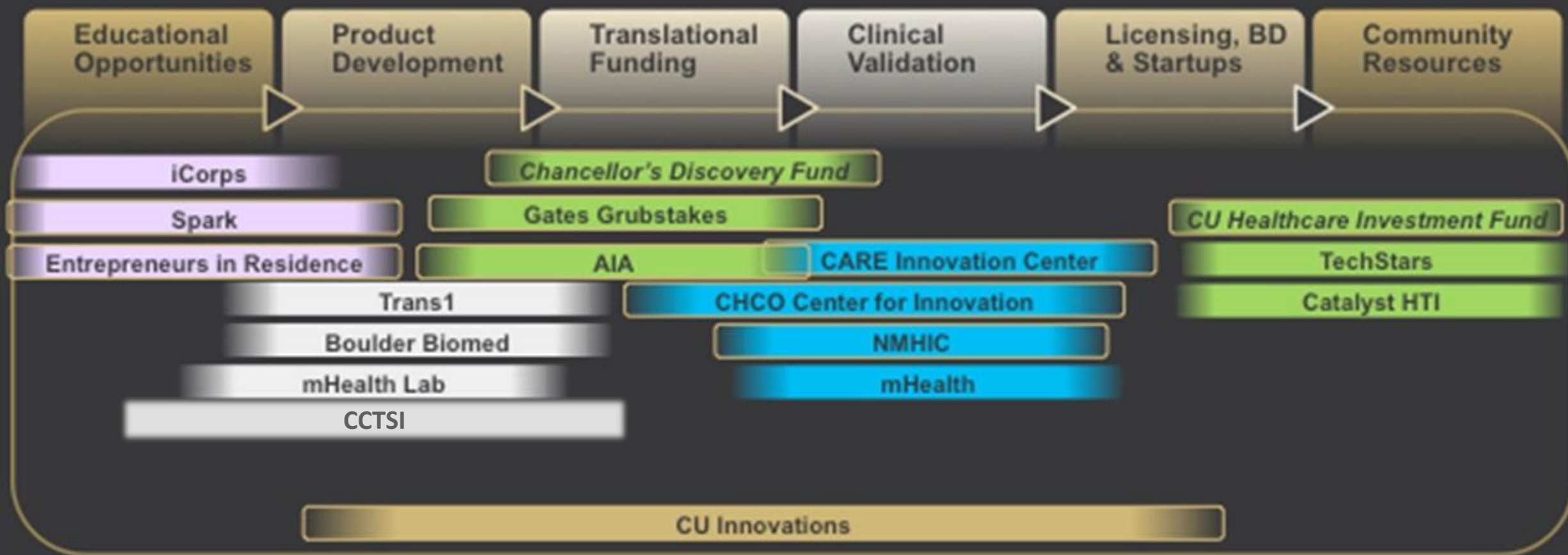

INNOVATION ECOSYSTEM

LAUNCH

COMMUNITY
RESOURCES

LICENSING
& STARTUPS

CLINICAL VALIDATION

PRODUCT DEVELOPMENT

TRANSLATIONAL FUNDING

EDUCATIONAL OPPORTUNITIES

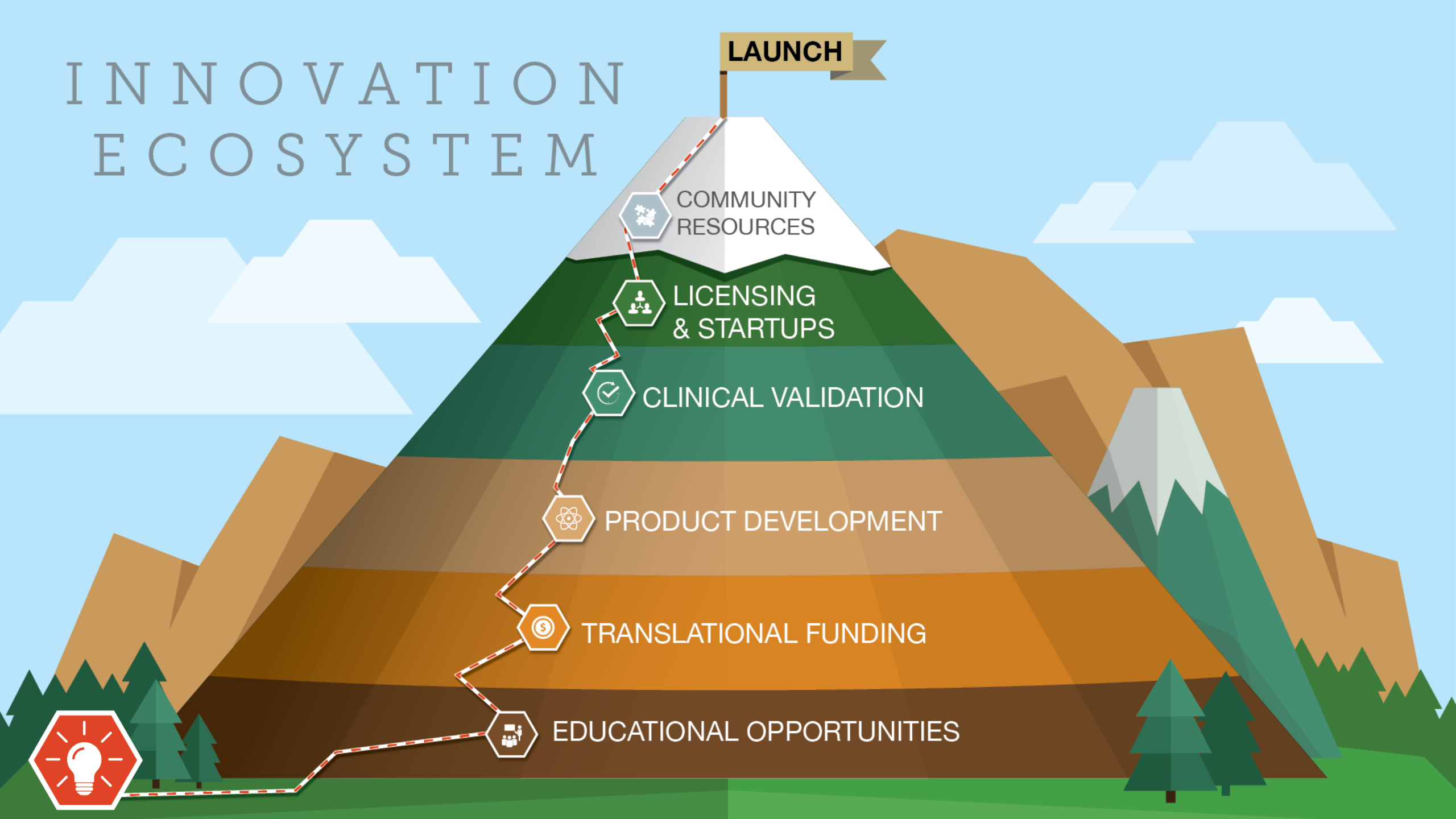

Ideas: Where They Come From

Internal



Over 200 invention disclosures submitted across **40** departments and divisions

External



Over 280 companies engaged for partnership & co-development



EDUCATIONAL OPPORTUNITIES

LAUNCH



COMMUNITY
RESOURCES



LICENSING
& STARTUPS



CLINICAL VALIDATION



PRODUCT DEVELOPMENT



TRANSLATIONAL FUNDING



EDUCATIONAL OPPORTUNITIES



Over 400 Attendees for CUI Education Programs



Women Leaders in Innovation Series



EDUCATIONAL OPPORTUNITIES



Education Initiatives Focused on 3 Areas of Innovations

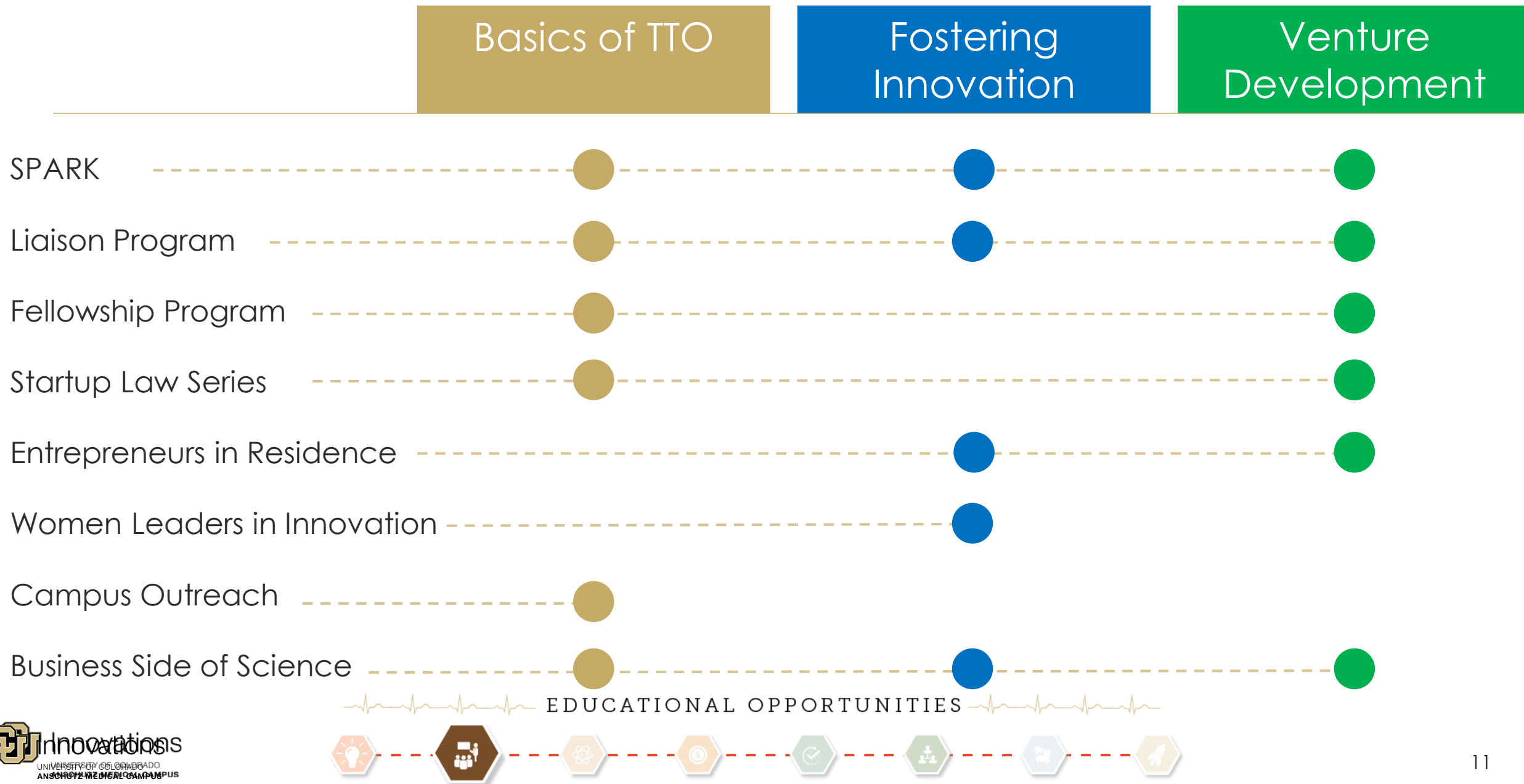

SPARK Colorado: Accelerator Program



Shifting academic discovery research into product development through:

Funding



Mentorship



Training

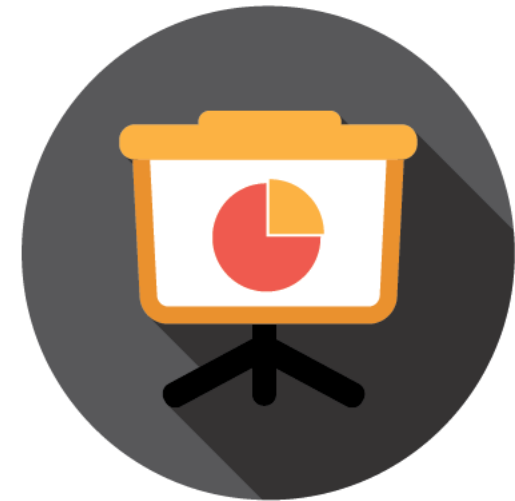

EDUCATIONAL OPPORTUNITIES



SPARK Program at AMC

Discovery

Clinic



Benefits to Participants

1. Mentorship

- a. Expert Advisors
- b. Product & Business Dev

2. Education

- a. Weekly Seminars
- b. Commercialization Strategies

3. Advising

- a. Access to Core Facilities
- b. Industry Partnerships

4. Funding

- a. \$50k/year - 2 years
- b. Goal = de-risk early stage projects

- 2 year accelerator program
- Up to **\$100k** per tech
- Top Industry Mentors



2018 INNOVATORS

SPARK Colorado aims to build a bridge between the scientist's lab bench and the patient's bedside by providing funding, industry mentorship, and a curriculum tailored for the needs of participating faculty and researchers. It seeks to help faculty navigate the "valley of death", a period during which a majority of promising projects fail to survive.

EVALINA BURGER, MD



MEDICAL DEVICE

Professor | Team Project:
Novel Cages Accommodating
Individual Endplate Architecture.

MELANIE JOY, PhD



MEDICAL DEVICE

Associate Professor | Team Project:
Novel Medical Device for Kidney
Disease Indication.

JEFF OLSON, MD



MEDICAL DEVICE

Associate Professor | Team Project:
Intraocular Device to Potentiate
Retinal Stem Cell Transplantation in
Macular Degeneration.

MAX MITCHELL, MD



MEDICAL DEVICE

Professor | Team Project:
Apical Cuff Implant Tool (ACIT) for
Left Ventricular Assist Device.

MICHAEL CHAPMAN, MD



Resident

Team Project:
tPA-Challenged Viscoelastometric Hemostatic Assay for Early
Identification of Fibrinolytic Coagulopathy in Trauma.

ERNEST MOORE, PhD



DIAGNOSTIC

Professor

VALERIA CANTO-SOLER, PhD



PHARMACEUTICAL

Associate Professor | Team Project:
Stem Cell-Derived 3d Retinal
Transplant for Dry Age-Related
Macular Degeneration.

MICHAEL GLODE, MD



PHARMACEUTICAL

Professor | Team Project:
A Fusion-toxin for the Treatment
of Bladder Cancer.

RICHARD JOHNSON, MD



PHARMACEUTICAL

Professor | Team Project:
Targeting Sugar and Alcohol:
Craving and Liver Disease.

JIM LAMBERT, PhD



PHARMACEUTICAL

Associate Research Professor
Team Project:
A Breakthrough Therapy for
Triple-Negative Breast Cancer.

MARK PETRASH, PhD



PHARMACEUTICAL

Professor | Team Project:
Biologic for Cataract Inhibition.

MARTY ZAMORA, MD



PHARMACEUTICAL

Professor | Team Project:
Autologous CD117+ Progenitor
Cell Therapy for Solid Organ
Transplantation.

SHI-LONG LU, MD, PhD



DIAGNOSTIC

Associate Professor | Team Project:
HNKlear: A Saliva-Based Molecular
Test for Head and Neck Cancer.

NICHOLAS WALTER, MD



DIAGNOSTIC

Assistant Professor | Team Project:
Surrogate Molecular Assessment
of Response to TB Treatment
(SMARTT-TB).

Advisors and Entrepreneurs In Residence

Steve Lindseth

Serial healthcare entrepreneur and investor



Collectively generated over
\$15B
in commercial value

Represent over
100 years
of commercialization expertise

Stanley Lapidus

Serial healthcare entrepreneur and investor



Wayne Guerra

Physician entrepreneur with multiple exits, CMO iTriage



Newly Added

Richard Foster

Executive in Residence, Yale Emeritus
Director of McKinsey & Company



David Lacey

Former Senior Vice President,
Discover Research at Amgen
Biopharmaceutical Consultant



EDUCATIONAL OPPORTUNITIES



TRANSLATIONAL FUNDING

LAUNCH



COMMUNITY
RESOURCES



LICENSING
& STARTUPS



CLINICAL VALIDATION



PRODUCT DEVELOPMENT



TRANSLATIONAL FUNDING



EDUCATIONAL OPPORTUNITIES



Commercialization Grant Funding Programs



**HEALTHCARE
INVESTMENT
FUND**

TRANSLATIONAL FUNDING



PRODUCT DEVELOPMENT

LAUNCH



COMMUNITY
RESOURCES



LICENSING
& STARTUPS



CLINICAL VALIDATION



PRODUCT DEVELOPMENT



TRANSLATIONAL FUNDING



EDUCATIONAL OPPORTUNITIES



CU Innovations Hub

Three Verticals of Innovation Resource Hub

- **Developing strategic partnerships** with industry facilitating the development of biomedical innovation
- **Provide additional access to mentors and resources** initiating and fueling startup companies
- **Effectively stewards CU Innovation funds** with internal and external collaborations.

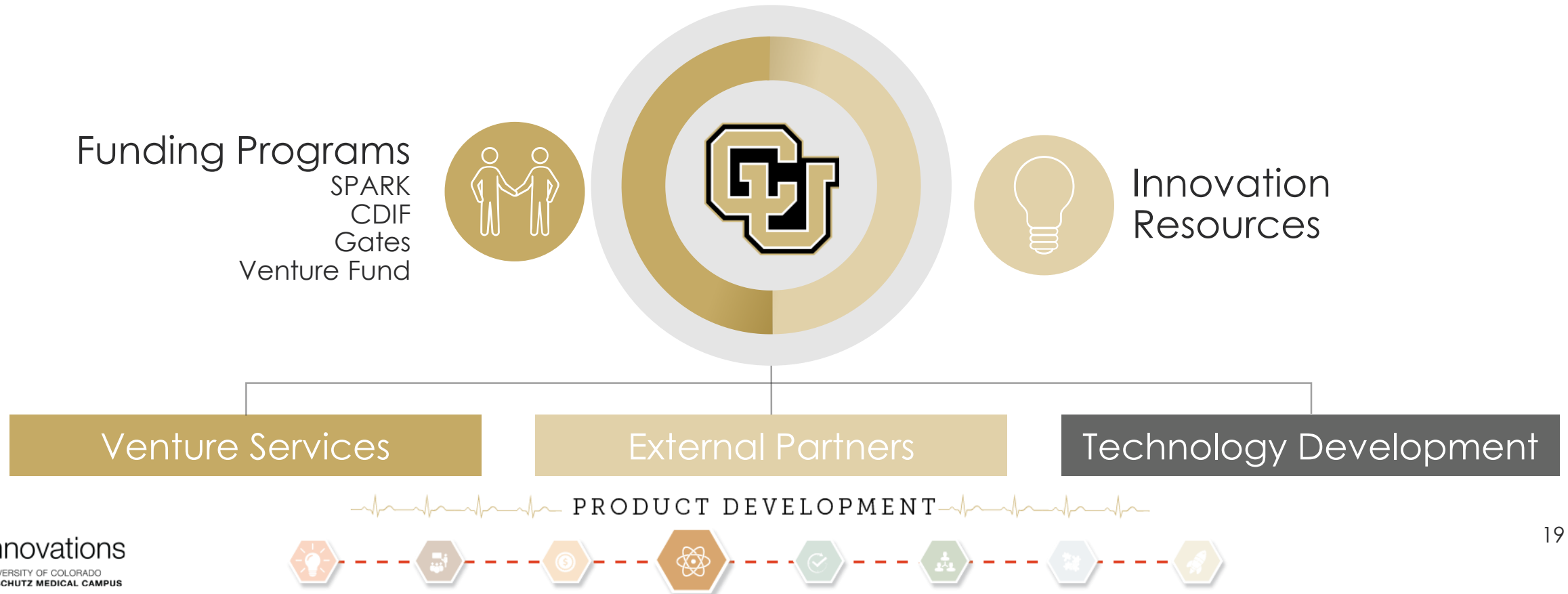

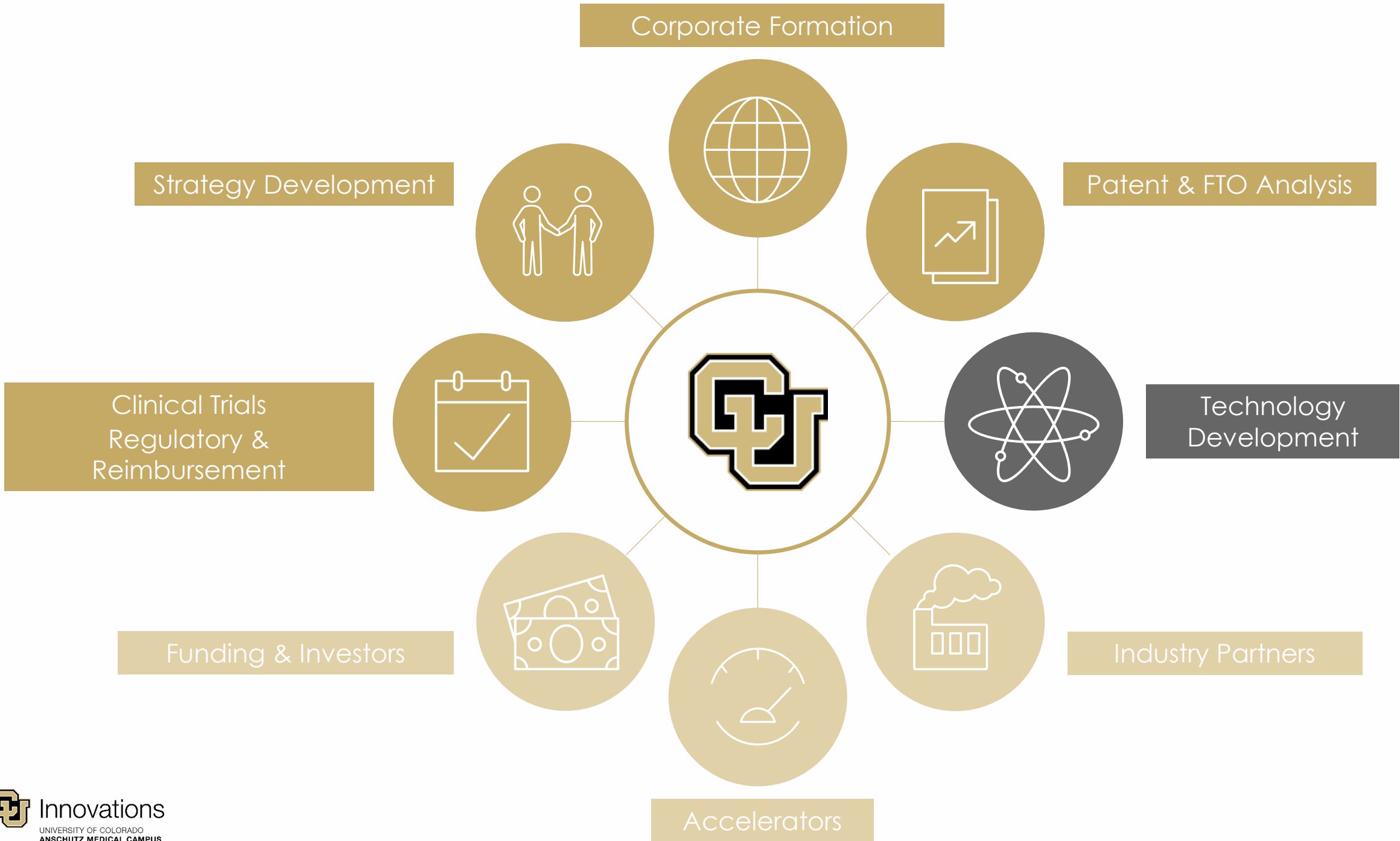

Corporate Formation

Assistance in legal, equity planning, and banking questions for establishing a startup company.

Patent & FTO Analysis

Access to Intellectual property law firms and mentors for: FTO analysis, patentability assessment, patent portfolio strategy development.

Strategy Development

Provide advisors and business fellows for developing business plans for successful startup launch.

Clinical Trials Regulatory & Reimbursement

Provide access to regulatory consultant assisting in the successful launch into the clinic.

Funding & Investors

Providing SBIR/STTR grant writing workshops and specialty consulting. Facilitating external partnerships by engaging industry and investors.

Industry Partners

Providing additional access point for industry partnerships opportunities.

Accelerators

Access to accelerator programs and incubator spaces.

Technology Development

Create portal to identify internal and external partners to develop your technology via university core laboratories and external partners.

CLINICAL VALIDATION

LAUNCH



COMMUNITY
RESOURCES



LICENSING
& STARTUPS



CLINICAL VALIDATION



PRODUCT DEVELOPMENT



TRANSLATIONAL FUNDING



EDUCATIONAL OPPORTUNITIES



Meanwhile, persistent inefficiencies and rising costs slowly bankrupt the country

US Healthcare Expenditures as % of GDP

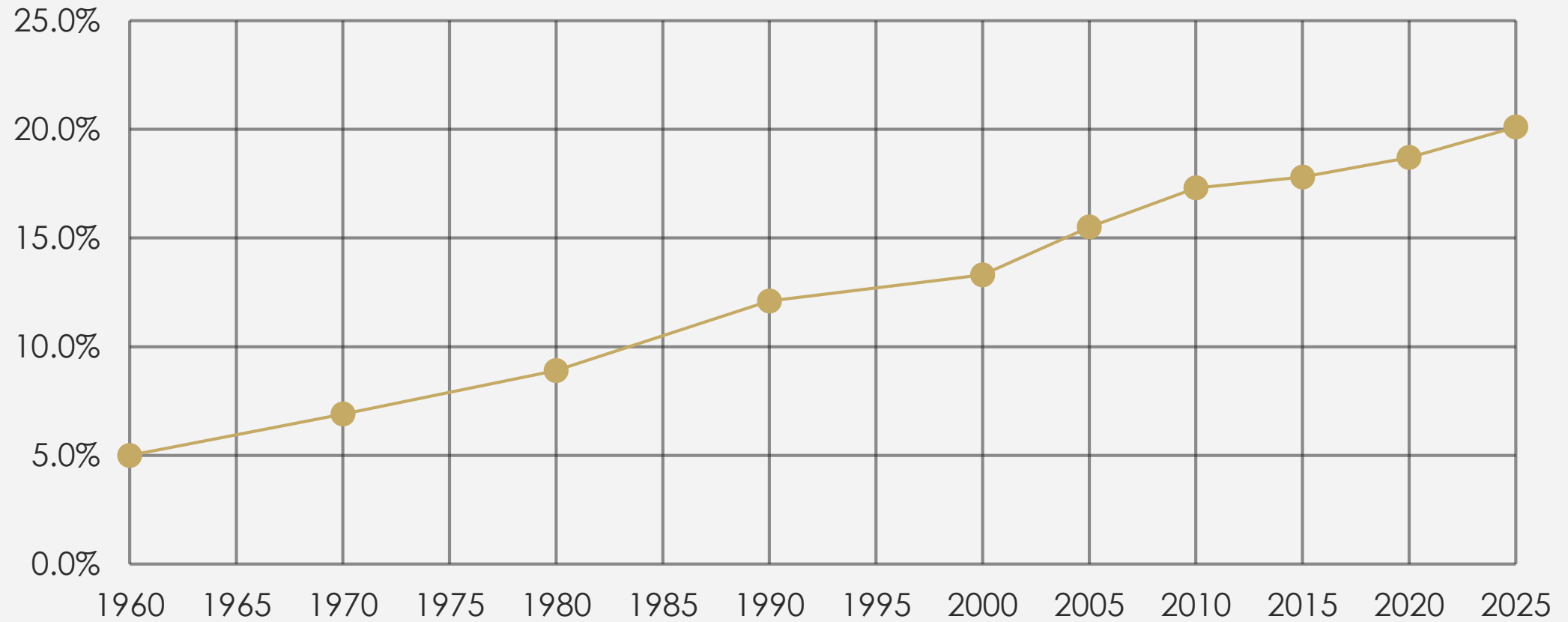

Healthcare is entering a new, promising era

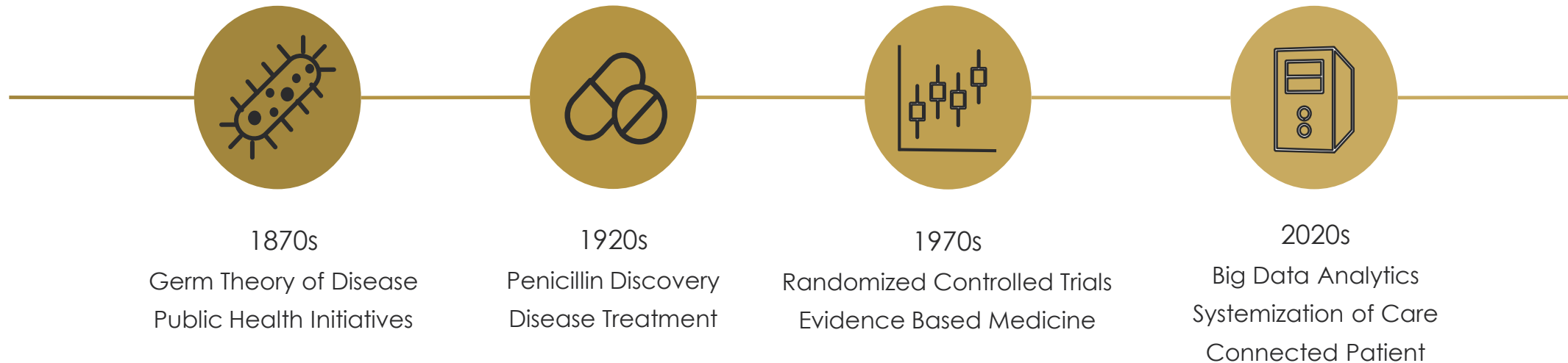

THE LAST MILE



“Patients and caregivers now expect rapid and personalized communication, to be an active participant in their care, and to be able to manage and access this information and their care team anytime and anywhere. Patients are now consumers, and they have high demands. Providers need to include patients and caregivers as part of the care team and engage with them through communication channels they use in their daily lives.” Ted Quinn

Connecting Campus Hospitals, CU Anschutz Researchers, & Industry Players to Develop Next Gen Healthcare Solutions

uchealth

CARE Innovation Center Recognized
as a Top Innovation Program,
2017

BECKER'S —————
HOSPITAL REVIEW



Children's Hospital Colorado

Top 20 Children's Hospitals in
Innovation and Technology by
Parents, 2018



500+

Companies applied for access to our
innovation centers at AMC since 2017

National Deal Flow

500+

Number of clinical validation and co-development opportunities
with innovation centers at the hospitals

uchealth

and



DRIVEN BY EXTERNAL PARTNERSHIPS



LICENSING & STARTUPS

LAUNCH



COMMUNITY
RESOURCES



LICENSING
& STARTUPS



CLINICAL VALIDATION



PRODUCT DEVELOPMENT



TRANSLATIONAL FUNDING



EDUCATIONAL OPPORTUNITIES



Title



COMMUNITY RESOURCES

LAUNCH



COMMUNITY
RESOURCES



LICENSING & STARTUPS



CLINICAL VALIDATION



PRODUCT DEVELOPMENT



TRANSLATIONAL FUNDING



EDUCATIONAL OPPORTUNITIES



Partnering with Global Networks



LAUNCH

LAUNCH

COMMUNITY
RESOURCES

LICENSING
& STARTUPS

CLINICAL VALIDATION

PRODUCT DEVELOPMENT

TRANSLATIONAL FUNDING

EDUCATIONAL OPPORTUNITIES



Successful Internal CU Anschutz Innovations

The total follow-on funding raised by these companies amounts to over \$6.2B

Medical Devices / Diagnostics

Nationally Ranked #1 in
Ophthalmology Innovation



Acquired by Alcon
for undisclosed sum



Acquired by OSI for
\$650M



CE Marked in EU
Clinical Trial in US

Biotech / Pharmaceuticals

Top 10 Drug Discovery University



SHINGRIX
HERPES ZOSTER VACCINE (NON-LIVE
RECOMBINANT, AS01_B ADJUVANTED)



BOTOX[®]



Kineret[®]
(anakinra)



Acquired by Gilead for \$2.5B



Acquired by Alexion for \$465M



Reverse Merger IPO at \$287M



Acquired by Merck for \$1.1B



Thank you!

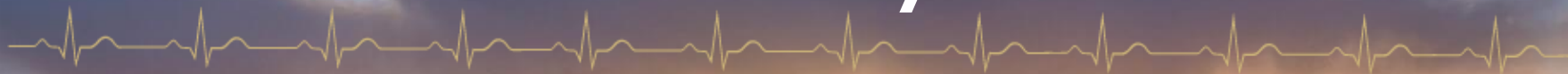

Innovations

UNIVERSITY OF COLORADO
ANSCHUTZ MEDICAL CAMPUS

Learn more: [Innovations.ucdenver.edu](https://innovations.ucdenver.edu)

Follow us on Twitter: @CUInnovations

Phone: (303) 724-3720

Email: cuinnovations@ucdenver.edu

Extra Slides



amazon NOVARTIS Apple VT Virtual Therapeutics caremerge

Google Medtronic PHILIPS

SAMSUNG RxREvU

cohero health LeanTaaS

Microsoft fitbit

nucleushealth CareDox

appliedVR

Technology

Need providers to test, improve, validate, and adopt/buy solutions

Health Systems
Control Access
to Point of Care

BlueCross. BlueShield. Humana.

aetna athenahealth

UnitedHealthcare

Cigna

oscar

Payers

Need providers to deliver care and explore new cost reduction models

Health
Systems



Control over
providers, patients,
and clinical data

uchealth



Children's Hospital Colorado

Improved Outcomes



University of Colorado
Anschutz Medical Campus

Chancellor's Initiatives

CU Anschutz Student Mental Health Re-Imagined

CU Anschutz Total Visits

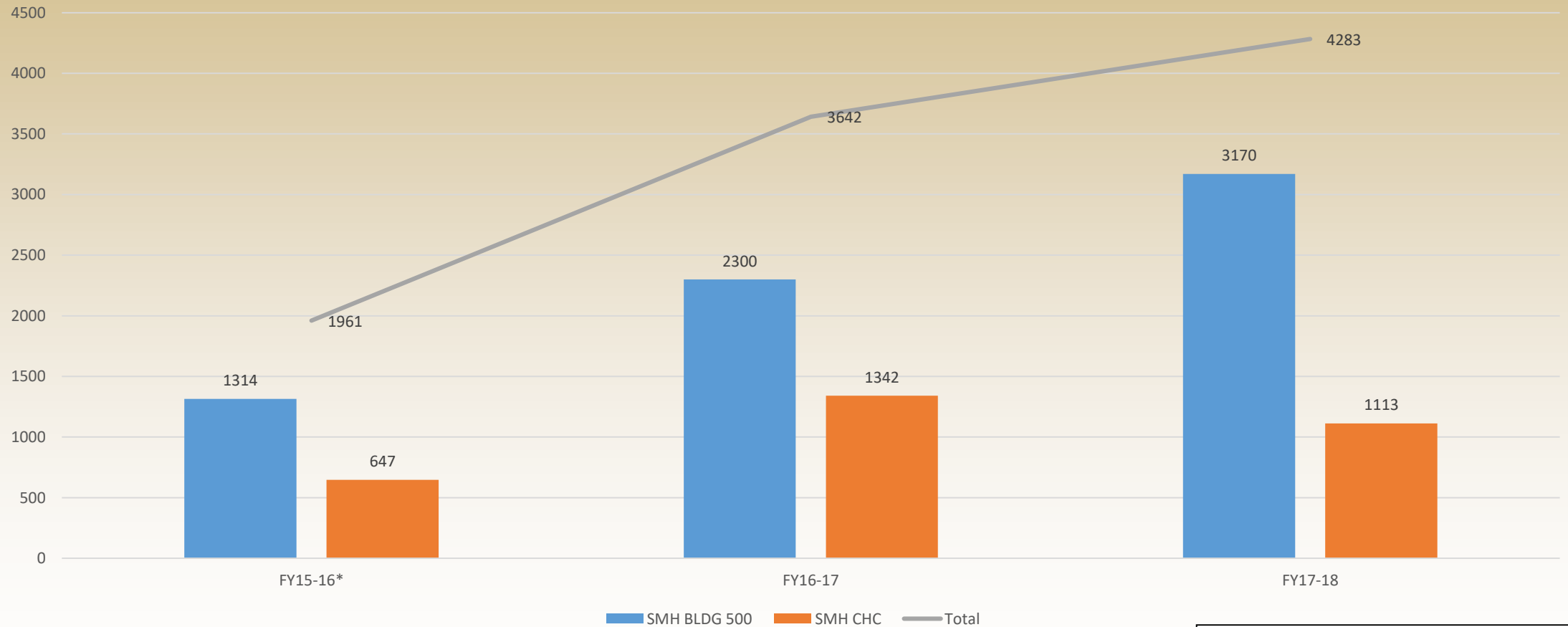

*FY15-16 includes only 9.15.15 – 6.30.16

Campus Working Group

- Brian Dwinnell (SOM)
- Shanta Zimmer (SOM)
- Eric Mediavilla (SoDM)
- Mary Dinger (ColoradoSPH)
- Shawna Cox (Grad School)
- Toni Qualantone (Pharmacy)
- Amy Barton (CON Student Mental Health)
- Rachel Davis (Student Mental Health)
- Melissa Sinclair (DOP Student Mental Health)
- Nicky Lowry (OCSS)
- Jan Gascoigne (AVC Student Affairs)
- Neil Krauss (Chancellors' Office)



Chancellor's Charge

- Improve efficiency to get clinical help
- Create a one-stop website
- Create an early awareness protocol
- Peer involvement and resiliency
- Improve faculty awareness and training



Proposal

POSITIONS

- Eating Disorder Psychiatrist (0.1 FTE)
- Dietician (0.2 FTE)
- Addictions Psychiatrist (0.1 FTE)
- Substance Use Counselor (0.4 FTE)
- Intake Coordinator (1.0 FTE)
- Student Wellness Navigator (1.0 FTE)
- Director of Student Wellness (.25 FTE)

Initiatives

- Combine student mental health clinics (AHWC and Psychiatry)
- YOU @ CU Anschutz
- Mental Health First Aid
- GRIT Peer Health Coaching



University of Colorado
Anschutz Medical Campus

Student Mental Health Support Re-Imagined

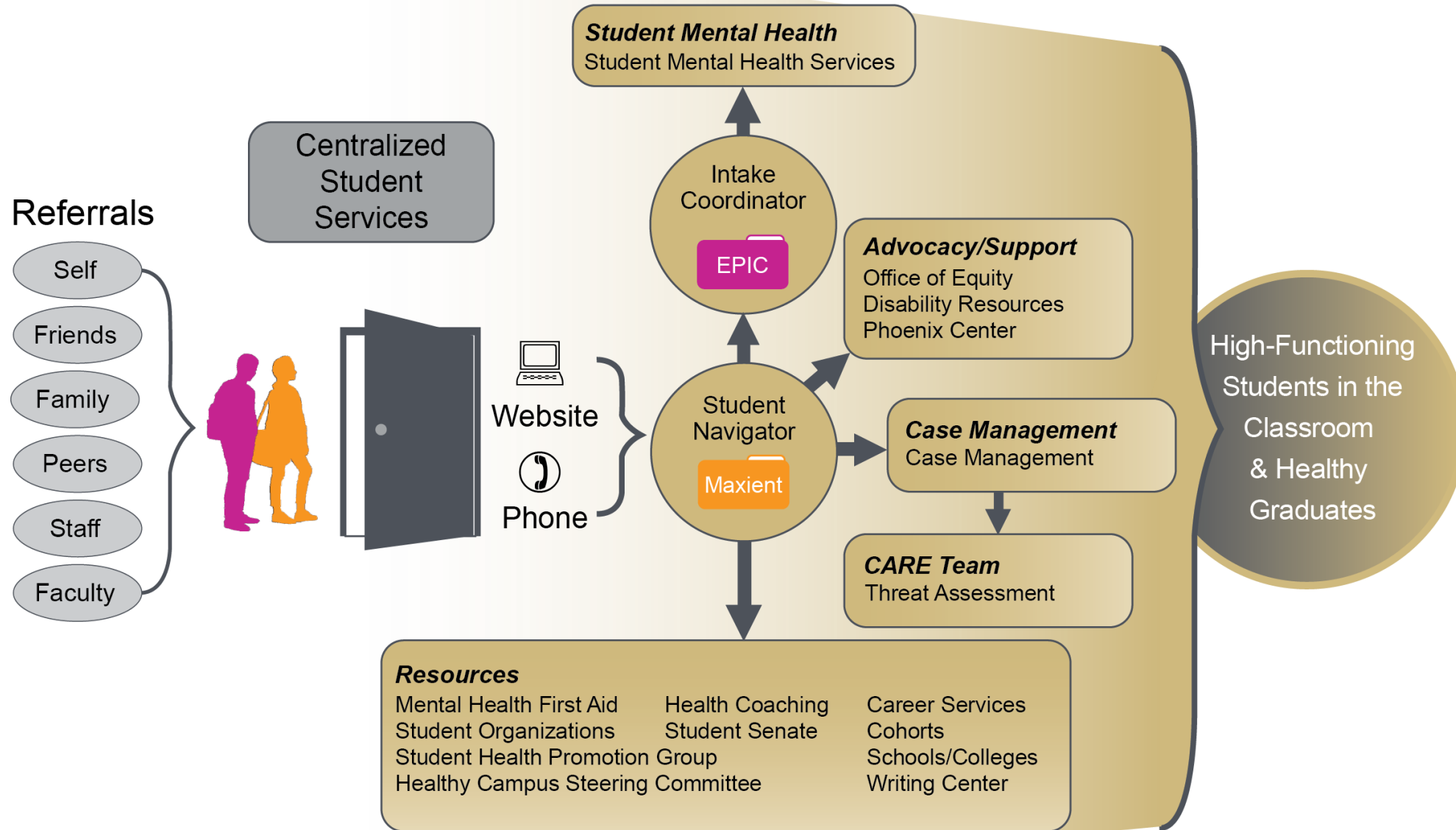

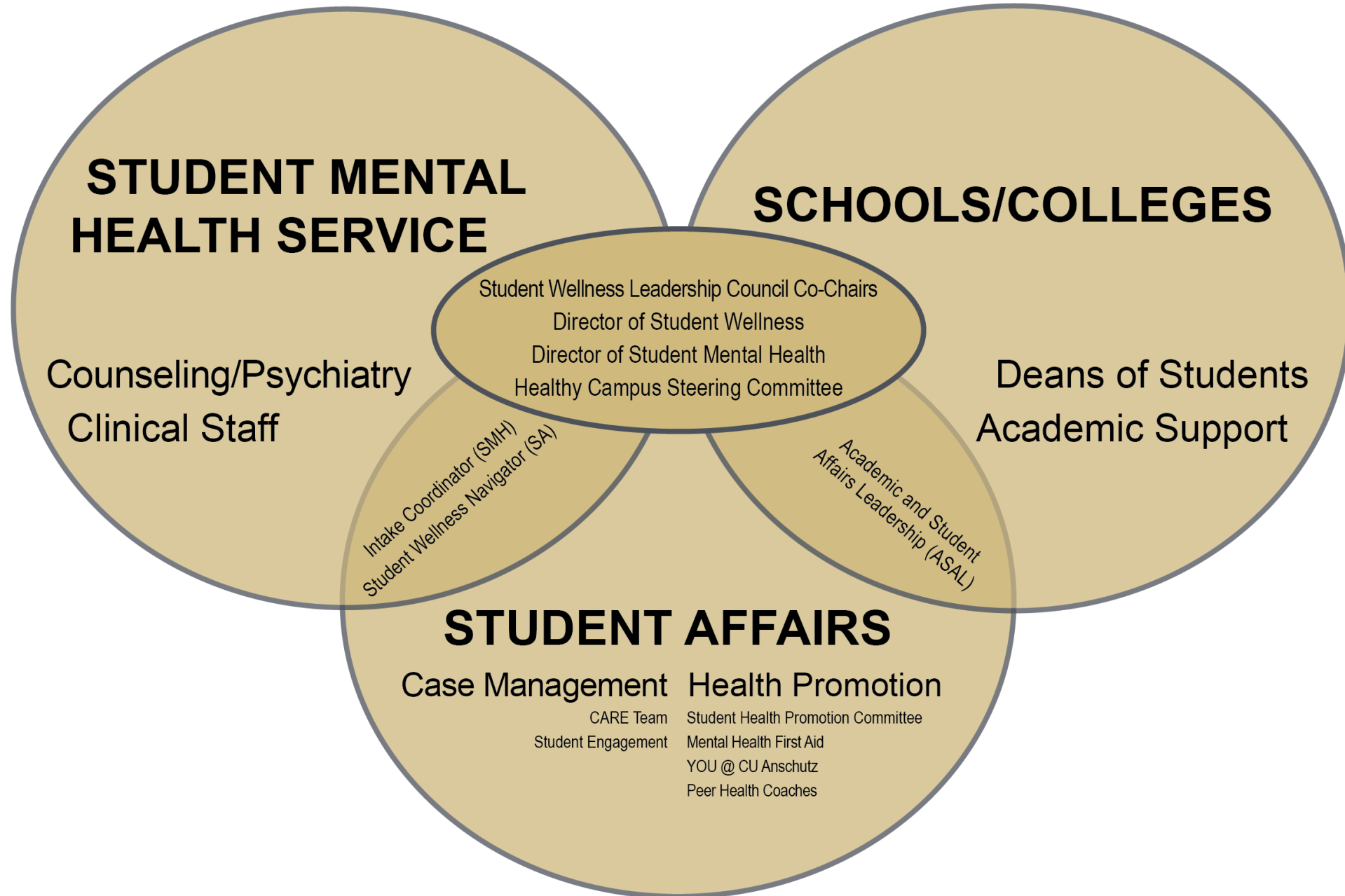

For more information

Jan Gascoigne, PhD, MCHES (Jan.Gascoigne@ucdenver.edu)

Assistant Vice Chancellor of Student Affairs

Rachel Davis, MD (Rachel.Davis@ucdenver.edu)

Medical Director, Student Mental Health



New private school for 3-year-olds to fifth grade; Tuition \$100 a month

Compositive Primary cultivates every child's
capacity to **reflect and learn, recognize and act, care and connect, and engage and
serve**

ADMISSIONS

Compositive Primary is currently accepting inquiries for enrollment for 3- and 4- year-old classrooms, kindergarten, and first grade for the 2019-2020 school year.

The school gives enrollment preference to children of parents working on the Anschutz Medical Campus, including faculty, staff and students of CU Anschutz, Children's Hospital Colorado, UCHealth's University Hospital, and the VA Medical Center.

www.compositiveprimary.org

Building a Partnership

Aurora Science & Tech and
The Anschutz Medical Campus



January 2019



University of Colorado
Anschutz Medical Campus

AURORA 
SCIENCE & TECH
A DSST PUBLIC SCHOOL

Overview of Student Learning at AST

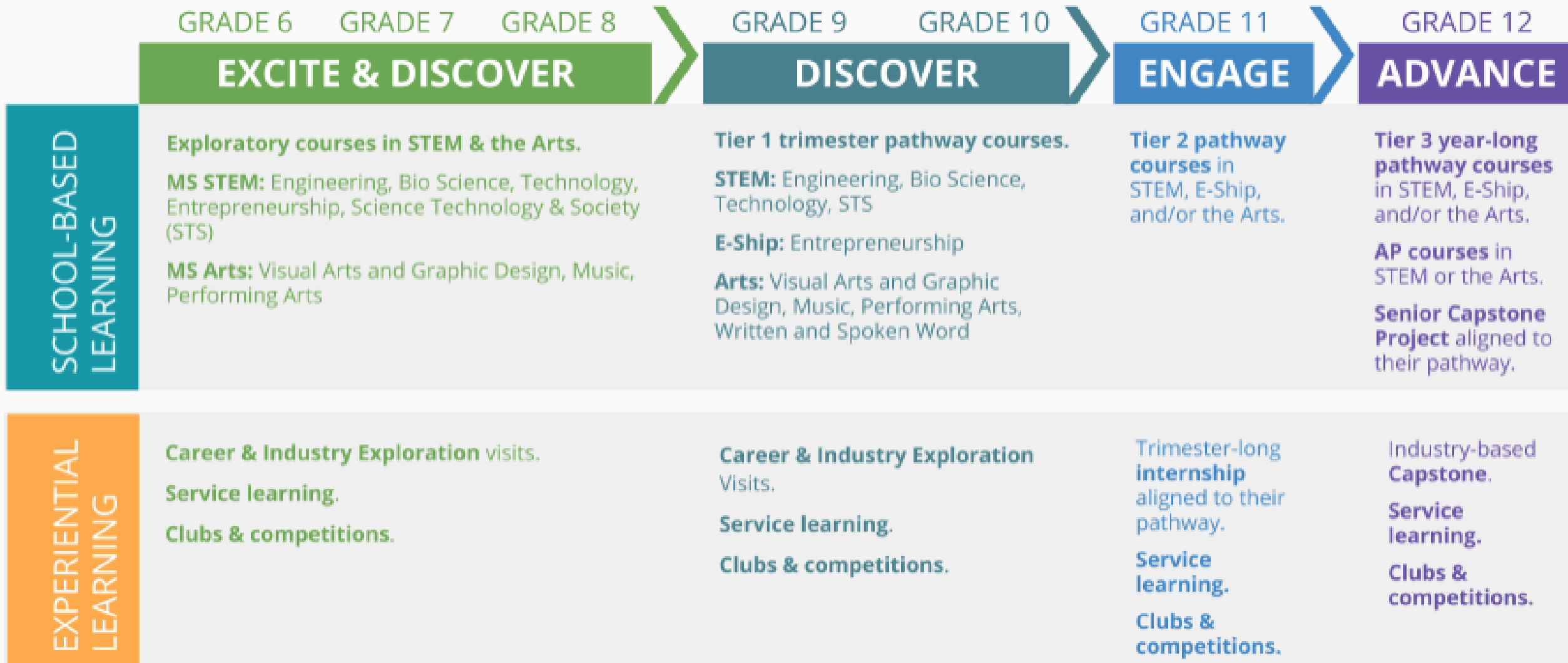

Our Challenge

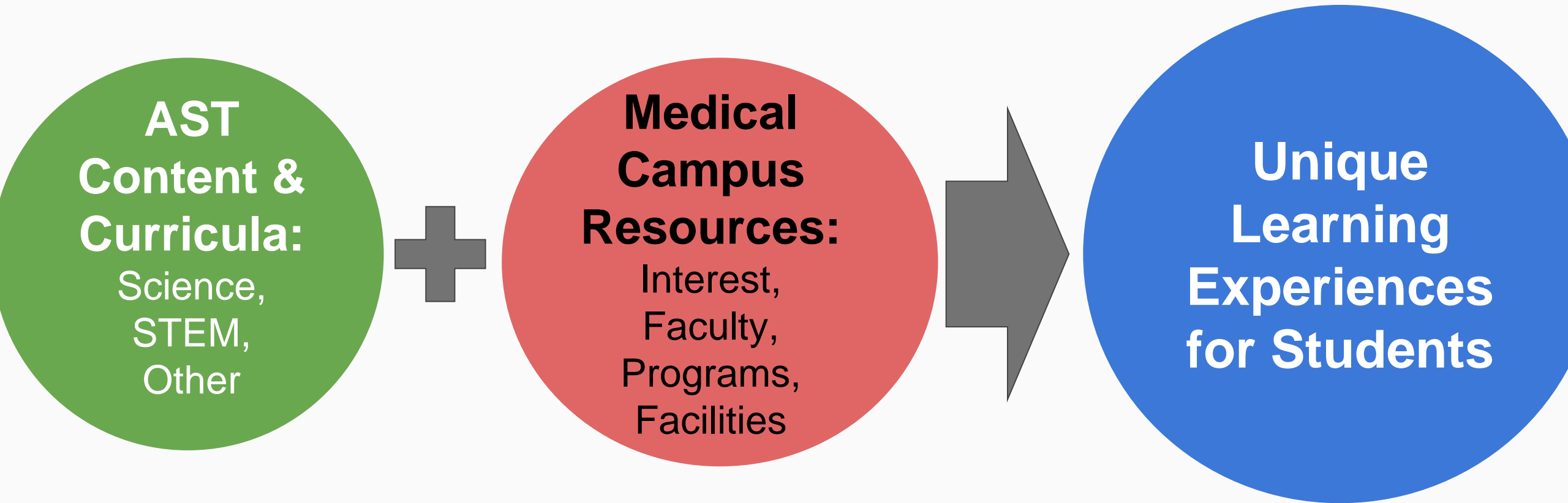

Potential Ways to Collaborate and Interact

- ❑ Guest speakers
- ❑ Anschutz-AST Student-to-student connections
- ❑ Post-doctoral engagement
- ❑ Labs
- ❑ Hospitals - clinical
- ❑ Hospitals - administration & operations
- ❑ Graduate student engagement
- ❑ Summer programs
- ❑ Bioscience industry
- ❑ Panels for student presentations of learning

Science and STEM Units and Topics	Trimester 1: Aug-Nov	Trimester 2: Nov-Feb	Trimester 3: Feb-May
<i>Unit 1: Practices of Science; Investigations; Use of Data;</i>	Overview of scientific methods Overview of various medical science fields Fundamentals of science research and labs Use of data in science		
<i>Unit 2: Geology & Life on Mars</i>	General conditions needed for life to exist		
<i>Unit 3: Matter & Interaction</i>	Changes in matter in different thermal environments		
<i>Unit 4 & 5: Geological Plates and impact on Geography</i>		Ethics in science and medical research Use of animals in science research Use of data in science Introduction to bioengineering: models and exemplars	
<i>Unit 6: Evolutionary History</i>			Evolution of organisms over time Evolution of antibiotic resistance Basic anatomical structures and evidence in fossil record
<i>Unit 7: Ecology and Biodiversity</i>			Interactions and impact of environmental factors and human health (and/or ecological health) Use of data in science

CU Science Discovery

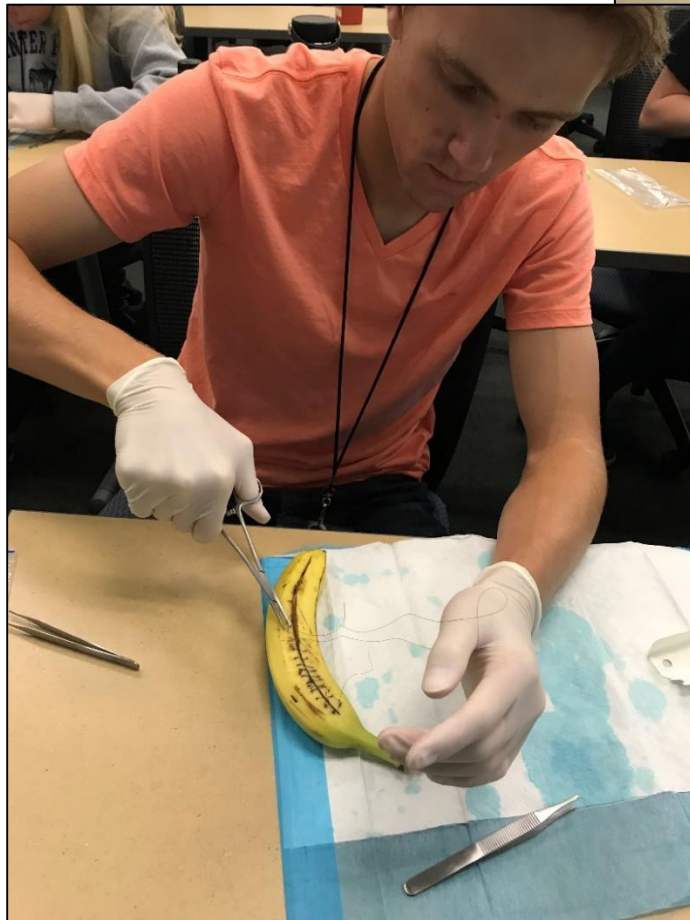

CU Science Discovery

- High School (rising 10th-12th graders)
 - Medical student experience (2)
 - Biomedical research bootcamp
 - Biomedical lab techniques
- Middle School (rising 7th through 9th graders)
 - AnatoME/Bioengineering
 - Microbes/Public health
 - Animal research/Poisons to potions
- Focus: NW Aurora, Denver metro, AHEC



Research space update

State of the School 2019:

Immediate Challenges:

- SPACE
 - Our simulation center (CAPE) has reached capacity
 - We are out of faculty office space
 - We are almost out of vivarium space
 - Our hospital partners are full or approaching full both outpatient and inpatient
 - We are becoming facility constrained
 - We are NOT out of wet lab space
- New leadership recruitments



- Research grant portfolio increased by ~4% this past year
 - Total awards \$504M
 - On-campus awards \$246M direct, \$85M indirect; total = \$331M (F&A = 35%)
 - Average \$ per sq ft of wet lab space = \$356 (up from \$310 in 2014-15)
 - National (aspirational) benchmark is probably ~\$450 per sq ft
 - Of 55 research units (departments/divisions/centers) 32 (57%) were below the \$356 benchmark and 36 (65%) were below the \$450 level
 - ~90K sq ft (or 18%) was below the \$356 benchmark and ~130K (or 25%) was below the \$450 benchmark

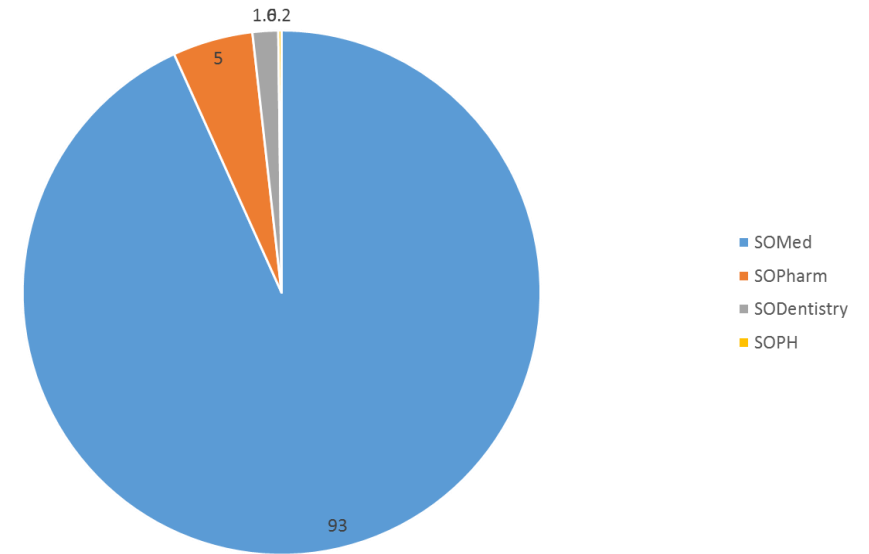

Is there inconsistent utilization in clinical versus basic units?

- Large clinical departments with significant research elements (Medicine, Pediatrics, Surgery)
 - Total footprint = 225K sq ft; 43% of total
 - 26,000 sq ft (12%) below mean benchmark
- Pure basic science departments (Biochemistry, CDB, Immunology, Pharmacology, Pharmacology)
 - Total footprint = 134K sq ft; 25% of total
 - 18,000 sq ft (14%) below mean benchmark
- Large truly hybrid units (Anesthesiology, Dermatology, Neurology, Ob/Gyn, Pathology)
 - Total footprint = 88K sq ft; 15% of total
 - 11,500 sq ft (13%) below mean benchmark

How can we optimize research space utilization?

- Research dollars per square foot is an imperfect surrogate
 - Wet versus Dry versus “Damp” require different metrics
 - People per square foot
- Utilization is not currently optimal

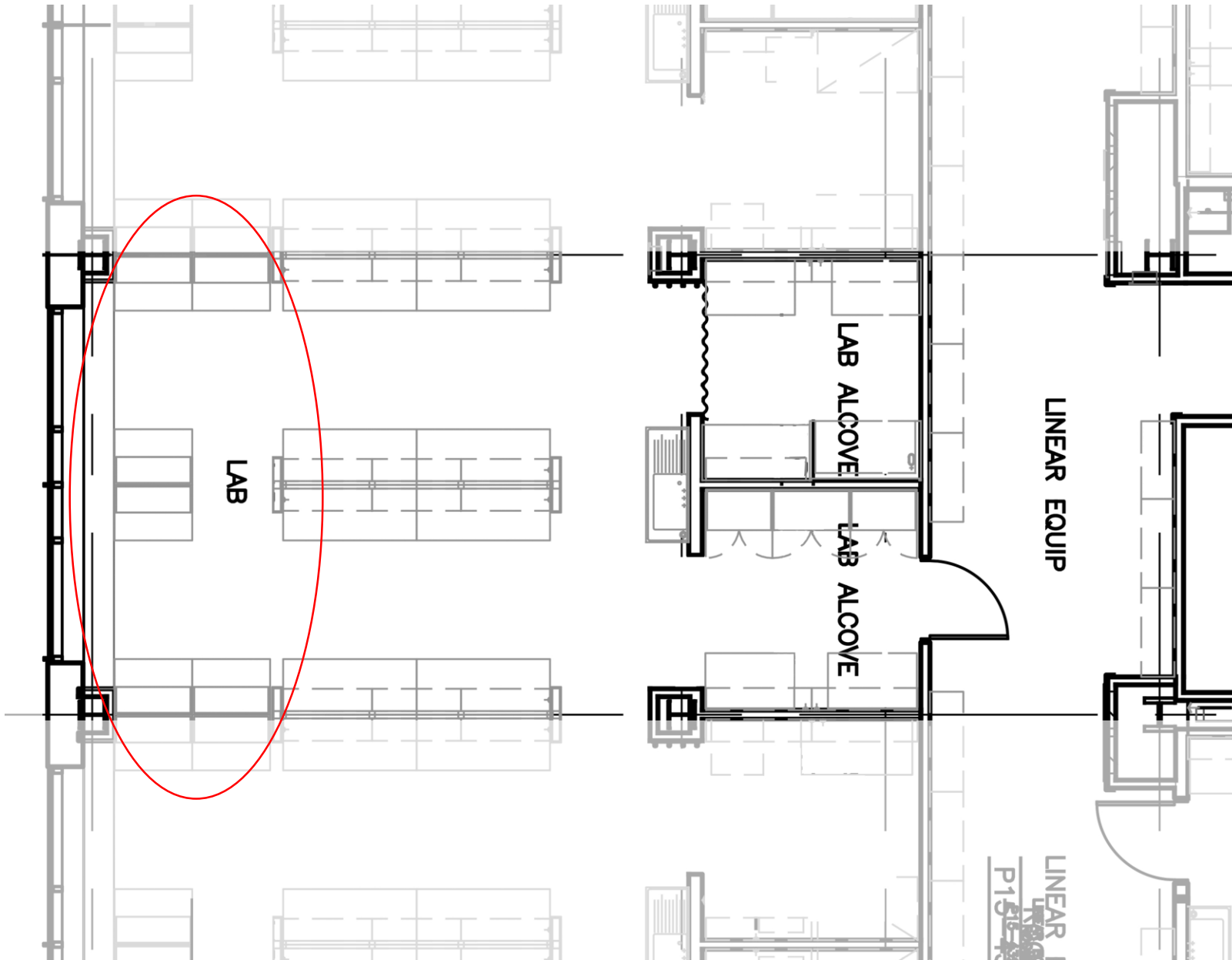

Alternative metric:
People per sq ft

~1000 sq ft lab module
6 desks/carels for lab staff

Current occupancy is ~2-3
people per module

Linear Equipment Room (LER) space



Bad



Good

Researchers hoard – think about how to be more efficient

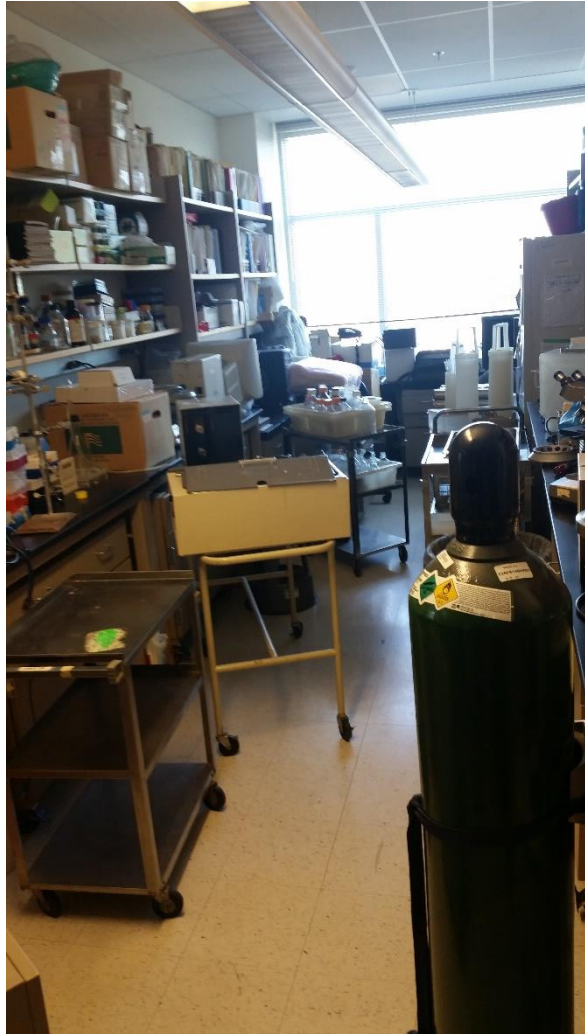

Bad



Also bad



Good

AO1 “Red Carpet Club”

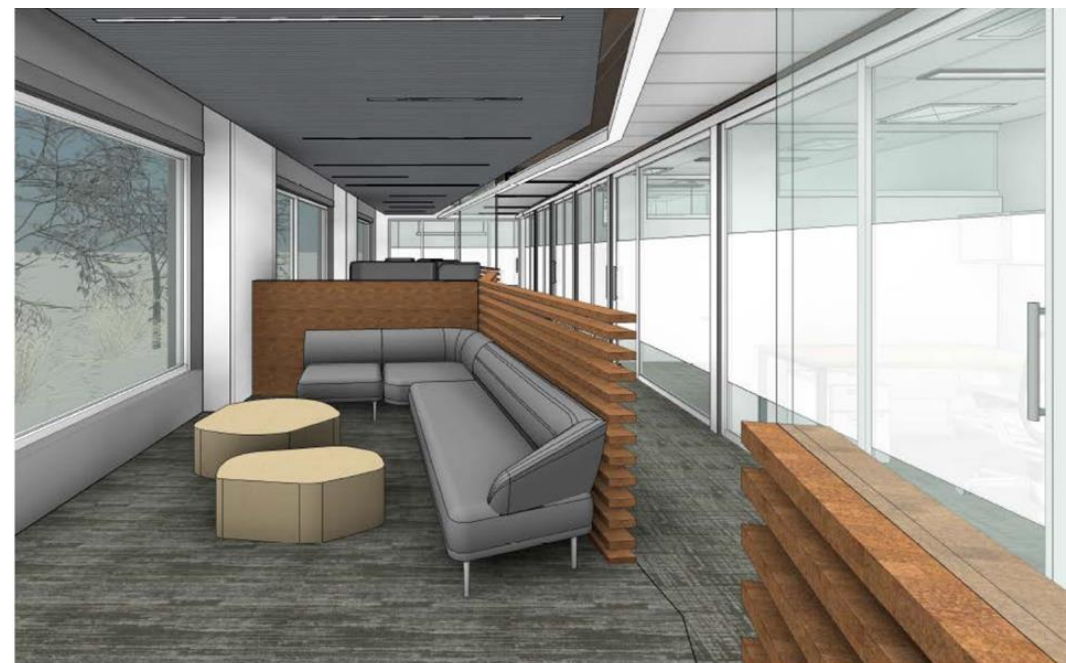

- Opening June –July 2019
- Many amenities
- Looking for more “volunteers”
(kudos to Otolaryngology, PM&R, Orthopedics, Emergency Medicine)
- Criteria for admission
- Clinically focused (>50% cFTE) – MD and APP
 - Emeritus and Affiliate faculty currently occupying offices
 - Others underutilizing assigned offices (**especially those in RC1/2**)
 - Tours starting in May/June

Send volunteer information (name, EID, current location) to
Suzann Ruedeman by Friday, March 8th